

Kitchen Cleaner & Degreaser

Health & Safety
Please refer to relevant MSDS



Don't forget
PPE

Do not rinse as
BioHygiene
special invisible
biofilms offer
residual
protection.

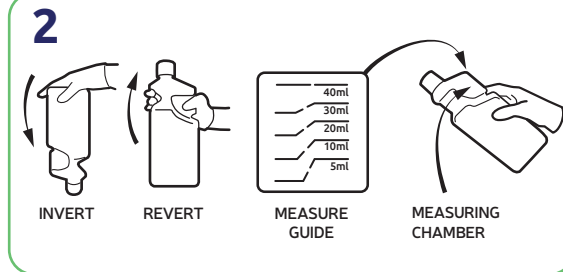

Tip bottle and use guide to measure correct dilution in the measuring chamber. Remove cap and pour.



Dilute 10ml of product into a trigger spray



Spray surface and wipe with a cloth. No need to rinse

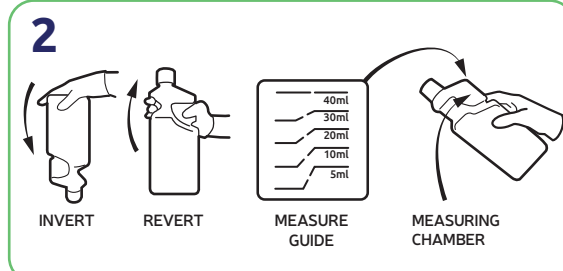

Tip bottle and use guide to measure correct dilution in the measuring chamber. Remove cap and pour.



Dilute 60ml of product into a bucket

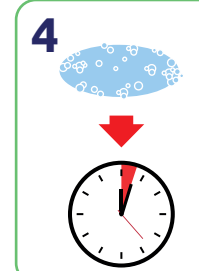

Allow a few minutes
contact time

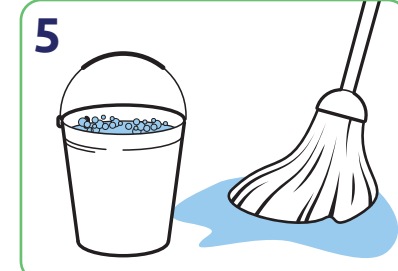

Mop surface. No need to rinse

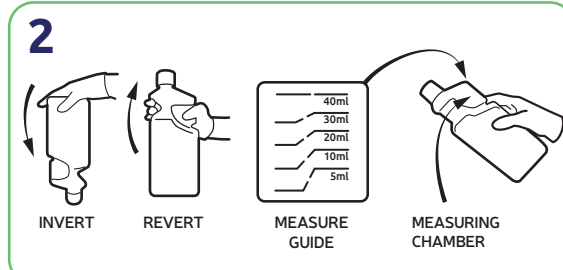

Tip bottle and use guide to measure correct dilution in the measuring chamber. Remove cap and pour.



Dilute 15ml of product into a trigger spray

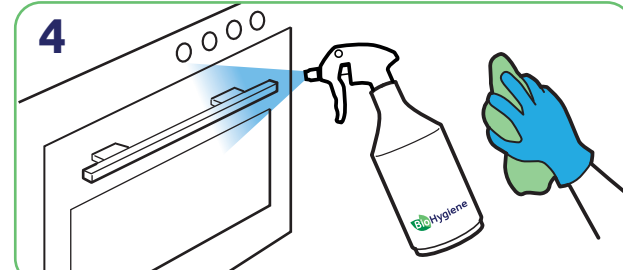

Spray surface and wipe with a cloth. No need to rinse